

FIBER OneShot™

Length Meter

Quick Reference Guide

Safety Information

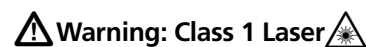

To prevent possible damage to your eyes caused by hazardous radiation:

- Do not look directly into optical connectors. Some optical equipment emits invisible radiation that can cause permanent damage to your eyes.
- Do not turn on the meter unless a fiber is attached to the port.
- Do not use a magnifying device to look at the optical outputs without the correct filter.
- Use of controls, adjustments, or procedures that are not in this manual can cause exposure to hazardous radiation.



To prevent damage to fiber connectors, to prevent data loss, and to make sure that your test results are as accurate as possible:

- Do not connect APC connectors to the meter. An APC connector will cause damage to the fiber endface in the connector on the meter.
- Use only patch cords that comply with GR-326-CORE specifications. Other patch cords can cause unreliable measurements.

- Use the correct procedures to clean all fiber connectors before each test. If you do not do this or if you use incorrect procedures, you can get unreliable test results and can cause permanent damage to the connectors.
- Put protective caps on all connectors when you do not use them.
- Do not connect the meter to a network that is on. If you do, the meter can cause problems in the network.
- If ACTIVE LINE blinks, immediately disconnect the meter from the fiber. Optical power levels more than +7 dBm can cause damage to the detector in the meter.

Battery Installation and Life

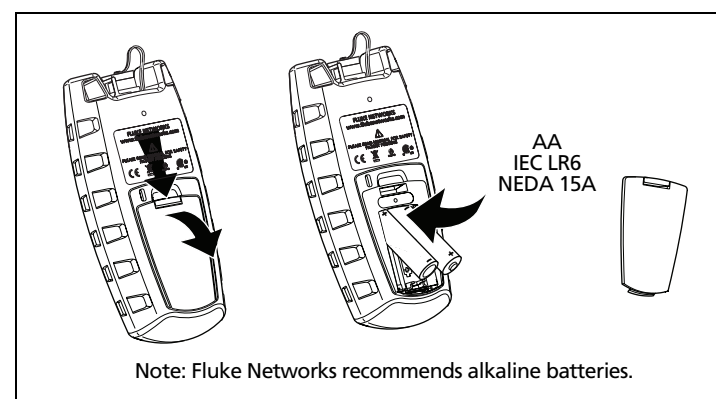

How to Install the Batteries

The meter can do approximately 1500 tests before you must replace the batteries.

Display Features

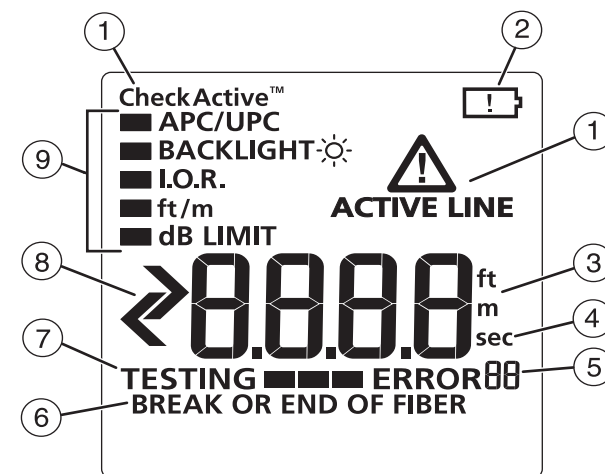

- CheckActive™ shows when the meter looks for an optical signal on the fiber. CheckActive™ and ACTIVE LINE blink if there is an optical signal on the fiber. The meter will not do a test if there is an optical signal on the fiber.
- When the low battery symbol shows, replace the batteries soon.
- The digits show the fiber length in feet or meters.
- Shows when you look at the setting for the backlight timer. The setting is in seconds.
- Shows an error number for error conditions.
- Shows when the meter completes a length measurement.
- Shows as the meter measures length.
- : Shows when the length is more than the range of the meter.
◀: Can show for short fibers when the meter cannot measure the length accurately.
- Settings for the meter.

Settings

To change the settings on the meter:

- Press **MENU SELECT**.
 - To select a setting to change, press **▼**, then press **MENU SELECT**.
 - Use **▲** **▼** to change the setting. See below for information on the settings.
 - Press **MENU SELECT** or **TEST** to save the setting.
- APC/UPC:** Angled Physical Contact/Ultra Physical Contact. If most cables you will do tests on have UPC connectors, set this to UPC.
 - BACKLIGHT:** Timer for the display backlight.
 - I.O.R.:** Index of refraction.
 - ft/m:** Unit for length measurements.
 - dB LIMIT:** Sets the minimum size of a reflection that the meter shows as a break or the end of the fiber when the reflection is before the end of the fiber.

How to Clean the Connector on the Meter

- Turn off the meter.
- Remove the connector adapter to get access to the ferrule (see "The Connector Adapter".)
- Touch the tip of an optical-grade solvent pen or swab soaked in solvent to a dry, optical-grade wiper.
- Touch a new, dry swab to the solvent on the wiper.
- Twist the swab around against the fiber endface 3 to 5 times, then twist a dry swab around against the fiber endface 3 to 5 times.

The Connector Adapter

The meter has an SC connector adapter that you can remove to clean the fiber endface in the port.

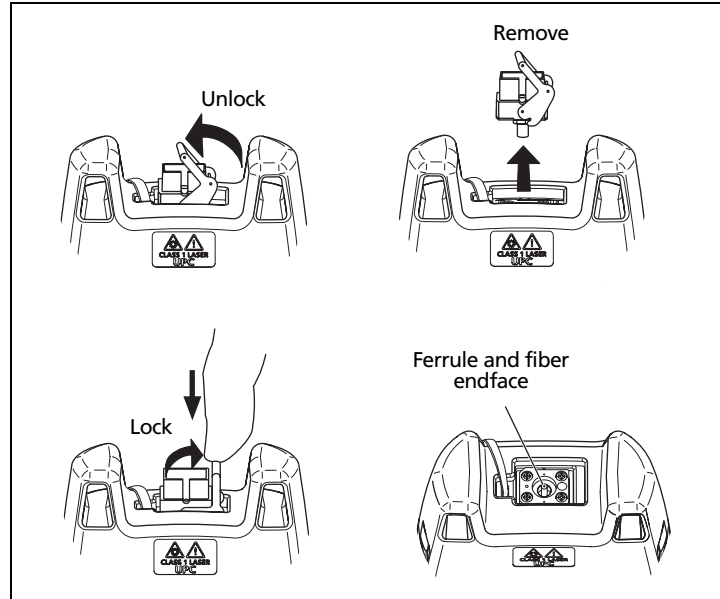

How to Remove and Install the Connector Adapter

How to Use the Meter

Notes

Always use patch cords that comply with GR-326-CORE specifications. Other patch cords can cause unreliable measurements.

Do not use the meter to measure fibers that have PC connectors. PC connectors cause large reflections that the meter shows as the end of the fiber.

- 1 Clean all fiber connectors.
- 2 Connect the fiber to the meter.

To connect to APC connectors, use a UPC/APC patch cord. To connect to UPC connectors, use a UPC/UPC patch cord.

- 3 Turn on the meter, then press .

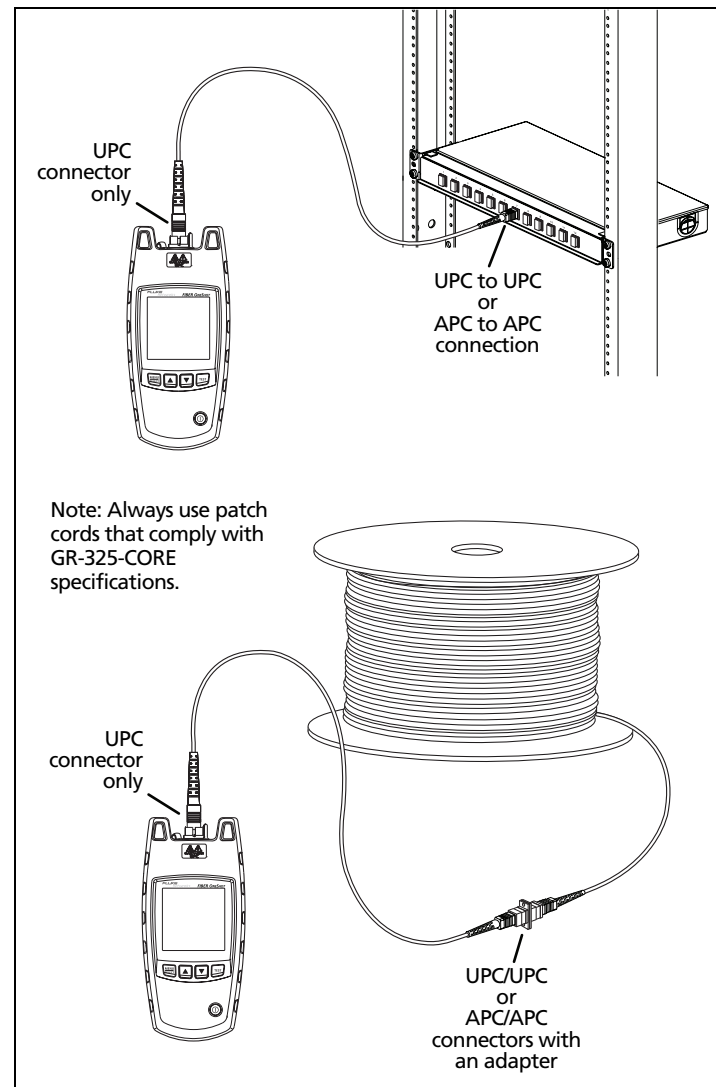

How to Make Connections

Contacting Fluke Networks

www.flukenetworks.com
 support@flukenetworks.com
 +1-425-446-4519

- Australia: 61 (2) 8850-3333 or 61 (3) 9329 0244
- Beijing: 86 (10) 6512-3435
- Brazil: 11 3759 7600
- Canada: 1-800-363-5853
- Europe: +44-(0)1923 281 300
- Hong Kong: 852 2721-3228
- Japan: 03-3434-0510
- Korea: 82 2 539-6311
- Singapore: +65-6799-5566
- Taiwan: (886) 2-227-83199
- USA: 1-800-283-5853

For more phone numbers, go to our website.

LIMITED WARRANTY AND LIMITATION OF LIABILITY

Fluke Networks mainframe products will be free from defects in material and workmanship for one year from the date of purchase. Parts, accessories, product repairs and services are warranted for 90 days, unless otherwise stated. Ni-Cad, Ni-MH and Li-Ion batteries, cables or other peripherals are all considered parts or accessories.

This warranty does not cover damage from accident, neglect, misuse, alteration, contamination, or abnormal conditions of operation or handling. Resellers are not authorized to extend any other warranty on Fluke Networks' behalf. To obtain service during the warranty period, contact your nearest Fluke Networks authorized service center to obtain return authorization information, then send your defective product to that Service Center with a description of the problem.

THIS WARRANTY IS YOUR ONLY REMEDY. NO OTHER WARRANTIES, SUCH AS FITNESS FOR A PARTICULAR PURPOSE, ARE EXPRESSED OR IMPLIED. FLUKE NETWORKS IS NOT LIABLE FOR ANY SPECIAL, INDIRECT, INCIDENTAL OR CONSEQUENTIAL DAMAGES OR LOSSES, ARISING FROM ANY CAUSE OR THEORY.

Since some states or countries do not allow the exclusion or limitation of an implied warranty or of incidental or consequential damages, this limitation of liability may not apply to you.

4/04

Fluke Networks
PO Box 777
Everett, WA 98206-0777
USA